

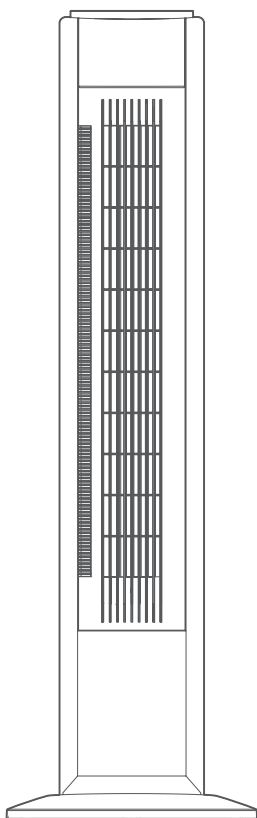

## **OWNER'S MANUAL**



### **Model**

**42" Plastic Oscillating Tower Fan  
FT-4230DxO-PBL**

***READ AND SAVE THESE INSTRUCTIONS***

Attention: Pictures in this manual are for reference only.



# **IMPORTANT SAFETY INSTRUCTIONS**

## **CAUTION**

Read rules for safe operation and instructions carefully.

## **WARNING**

1. This appliance has a polarized plug (one blade is wider than the other). To reduce the risk of electric shock, this plug is intended to fit in a polarized outlet only one way. If the plug does not fit fully in the outlet, reverse the plug. If it still does not fit, contact a qualified electrician. Do not attempt to defeat this safety feature.
2. **WARNING - To reduce the risk of fire or electric shock, Do not use this fan with any solid-state speed control device.**
3. Keep electrical appliances out of reach from children or infirm persons. Do not let them use the appliances without supervision.
4. If the power cord is damaged, it must be replaced by manufacturer or its service agent or a similarly qualified person in order to avoid a hazard.
5. This appliance is not intended for use by persons (including children) with reduced physical, sensory or mental capabilities, or lack of experience and knowledge, unless they have been given supervision or instruction concerning use of the appliance by a person responsible for their safety. Young children should be supervised to ensure that they do not play with the appliance.
6. Once the fan has been assembled, the motor blade guard shall not be removed.
  - Prior to cleaning, unplug the fan.
  - The rotor guard shall not be disassembled/opened to clean the rotor blades.
  - Wipe the fan enclosure and rotor blade guard with a slightly damp cloth.
7. This product employs overload protection (fuse). A blown fuse indicates an overload or short-circuit situation. If the fuse blows, unplug the product from the outlet. Replace the fuse as per the user servicing instructions (follow product marking for proper fuse rating) and check the product. If the replacement fuse blows, a short-circuit may be present and the product should be discarded or returned to an authorized service facility for examination and/or repair.
  - a) "Do not operate any fan with a damaged cord or plug. Discard fan or return to an authorized service facility for examination and/or repair."
  - b) "Do not run power cord under carpeting. Do not cover power cord with throw rugs, runners, or similar coverings. Route power cord under furniture or appliances. Arrange cord away from traffic area and where it will not be tripped over."



## **WARNING: Chemical Burn Hazard. Keep batteries away from children.**

This product contains a lithium button/coin cell battery. If a new or used lithium button/coin cell battery is swallowed or enters the body, it can cause severe internal burns and can lead to death in as little as 2 hours. Always completely secure the battery compartment. If the battery compartment does not close securely, stop using the product, remove the batteries, and keep it away from children. If you think batteries might have been swallowed or placed inside any part of the body, seek immediate medical attention.

## **RULES FOR OPERATION**

1. Never insert fingers, pencils, or any other object through the grille when fan is running.
2. Disconnect fan when moving from one location to another.
3. Be sure fan is on a stable surface when operating to avoid tipping.
4. **DO NOT** use fan in window, rain may create electrical hazard.
5. Indoor use only.

## PRODUCT PROFILE



### NOTE:

The pictures contained in the manual are for reference only, and it is subject to the physical product in the packing box.

## NAME OF COMPONENTS

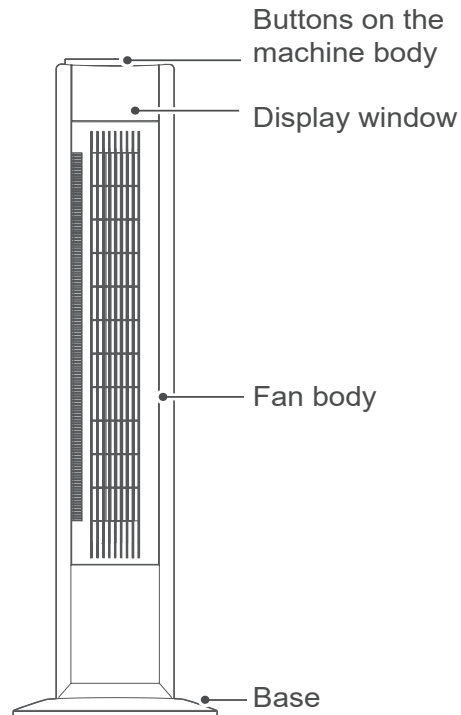

## ASSEMBLY INSTRUCTIONS

### NOTE:

Please place the fan on the package foam or other soft surfaces and invert it to avoid scratch marks when installing the base.

- 1 Take out the two parts of the base from packing box. Then, align the centers of the two parts of the base and place them in a crossed form. Rotate one of the two bases to alignment hole for correct assembly.

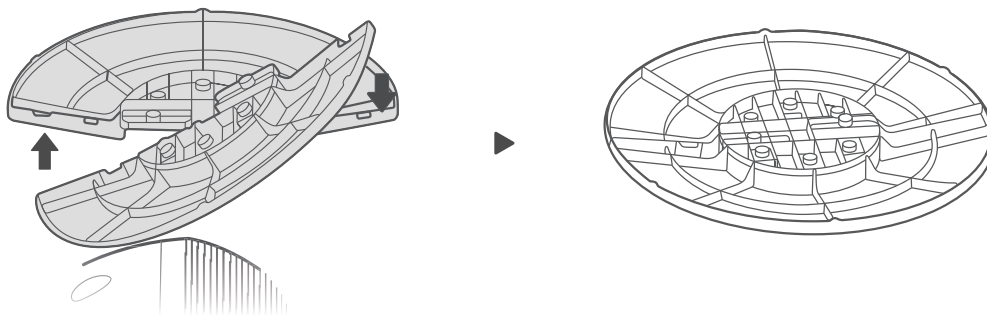

- 2 Remove four screws from the fan body prior to installation of the base on the fan body when once the base and fan body are aligned accurately. Install and tighten the base to the fan body.

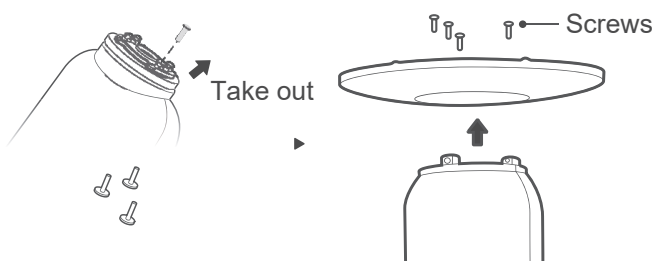

## USE INSTRUCTIONS

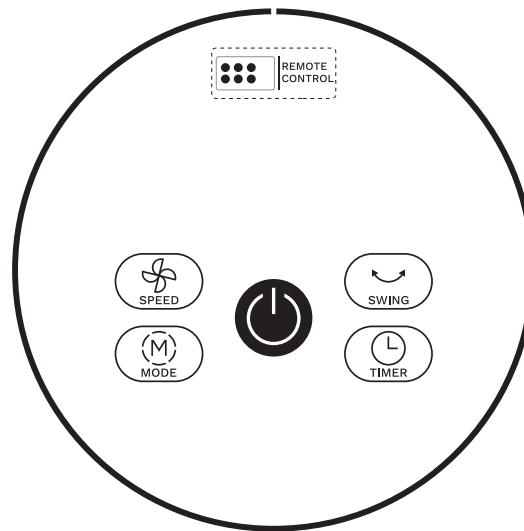

Press "Fan speed" to adjust the speed from shift 1 to 3.

Press "Timer" to adjust the time:

Set timed power off between 1 hour and 8 hours in starting up status;

Set appointed starting up between 1 hour and 8 hours in standby status (power on but without starting up).

Press "Mode" to adjust wind type (Normal wind, sleep wind, natural wind).

Press "Oscillating" to start or stop totation of the fan head.

## DISPLAY PANEL

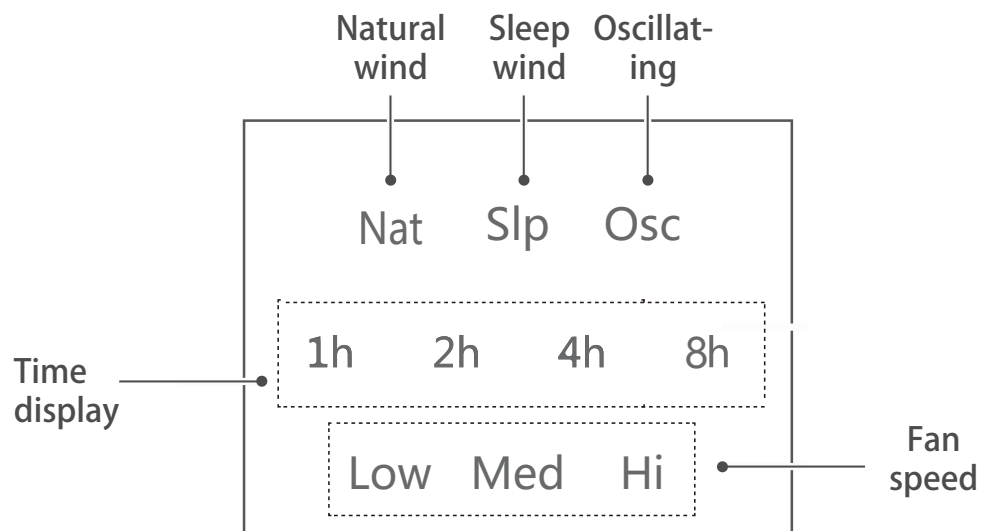

REMOTE CONTROL BUTTON / FUNCTIONS

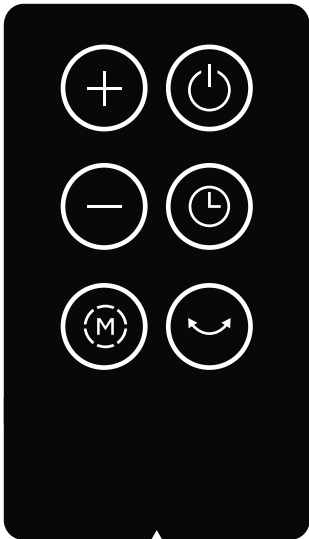

	Start up/Standby key
	Function key
+	"+" key
-	"-" key
	Timer key
	Swing key

CIRCUIT DIAGRAM

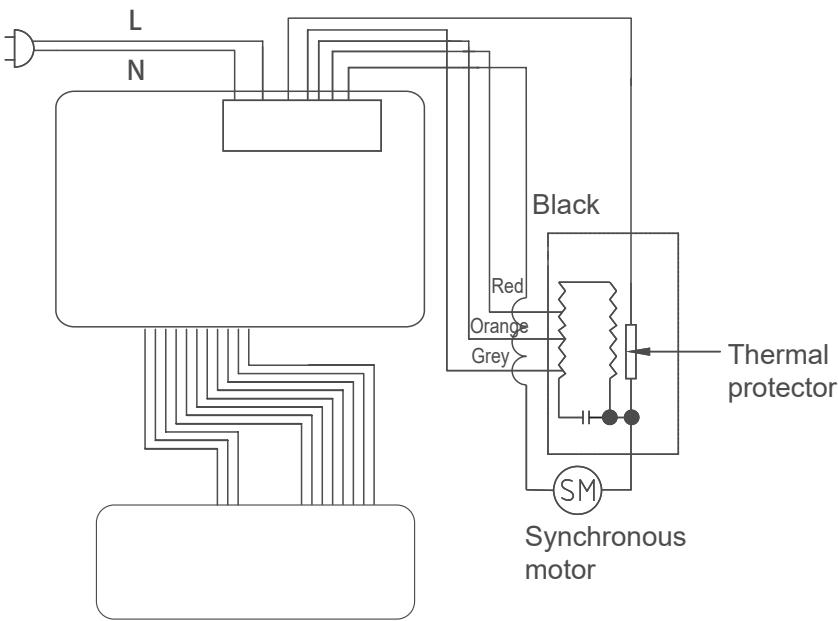

## USER SERVICING INSTRUCTIONS

- a) Grasp plug and remove from the receptacle or other outlet device.  
Do not unplug by pulling on cord.
- b) Open fuse cover. Slide open fuse access cover on top of attachment plug towards blades.
- c) Remove fuse carefully. Insert the tip of your tool into fuse slot (close with the terminal), then pry the fuse gradually and slowly, but not overexert. If you feel tight, you can try it at several times and pry the fuse little by little. When one side of the fuse has been pry, then you can remove the fuse out entirely.
- d) Risk of fire. Replace fuse only with 2.5 Amp, 125 Volt fuse.
- e) Close fuse cover. Slide closed the fuse access cover on top of attachment plug.
- f) Risk of fire. Do not replace attachment plug. Contains a safety device (fuse) that should not be removed.  
Discard product if the attachment plug is damaged.

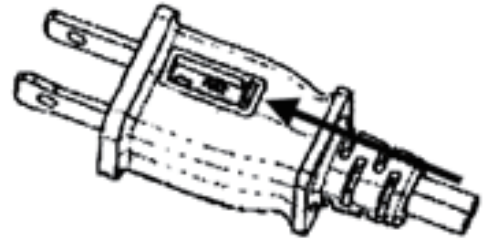

## CLEANING

1. Be sure to unplug from the electrical supply source before cleaning.
2. Plastic parts should be cleaned with mild soap and a damp cloth or sponge. Rinse to remove soap film with clean water.
3. Be sure not to prevent water or other liquid from entering the motor.

## RULES FOR OPERATION

1. Never insert fingers, pencils, or any other object through the grille when fan is running.
2. Disconnect fan when moving from one location to another.
3. Be sure fan is on a stable surface when operating to avoid overturning.
4. DO NOT use fan in window, rain may create electrical hazard.
5. Household use only.

## LIMITED EXPRESS WARRANTY

Congratulations on purchasing your new HVAC equipment. It's been designed for long life and reliable service, and is backed by one of the strongest warranties in the industry. Your item automatically qualifies for the warranty coverage listed below, providing you keep your proof of purchase (receipt) for the equipment and meet the warranty conditions.

### LIMITED ONE (1) YEAR EXPRESS WARRANTY

Comfort-Aire warrants item to be free from defects in workmanship and materials for normal use and maintenance for one (1) year from the date of purchase by the original consumer. This Express Limited Warranty applies only when operated per Comfort-Aire installation and operating instructions for normal use.

### EXCEPTIONS

The Limited Express Warranty does not cover normal maintenance. Comfort-Aire recommends that regular inspection/maintenance be performed at least once a season.

### CONDITIONS FOR WARRANTY COVERAGE

Item must be operated according to Comfort-Aire operating instructions included with the unit and cannot have been subjected to accident, alteration, improper repair, neglect or misuse, or an act of God (such as a flood)

- Serial numbers and/or rating plate have not been altered or removed
- Performance cannot be impaired by use of any product not authorized by Comfort-Aire, or by any adjustments or adaptations to components
- Damage has not been a result of inadequate wiring or voltage conditions, use during brown-out conditions, or circuit interruptions

### DURATION OF WARRANTY & REGISTRATION

The warranty begins on the date of purchase by the original consumer. The consumer must retain a receipt as proof of warranty period. Without this proof, the express warranty begins on the date of shipment from the factory.

### REMEDY PROVIDED BY THE LIMITED EXPRESS WARRANTY

The sole remedy under the Limited Warranty is replacement of the defective unit. Labor to diagnose and replace the defective unit is not covered by this Limited Express Warranty. If for any reason the replacement product is no longer available during the warranty period, Comfort-Aire shall have the right to allow a credit in the amount of the current suggested retail price of the product instead of providing replacement.

### LIMITATION OF LIABILITY

1. There are no other express or implied warranties. Comfort-Aire makes no warranty of merchantability. We do not warrant that the item is suitable for any particular purpose or can be used in buildings or rooms of any particular size or condition except as specifically provided in this document. There are no other warranties, express or implied, which extend beyond the description in this document.
2. All warranties implied by law are limited in duration to the one-term of the warranty. We will not be liable for any consequential or incidental damages caused by any defect in this item.
3. This warranty gives you specific legal rights and you may also have other rights which vary from state to state. Some states do not allow limitation on how long an implied warranty lasts or do not allow the exclusion or limitation of incidental or consequential damages, so the above limitations or exclusions may not apply to you.
4. No warranties are made for items sold outside the continental United States and Canada. Your distributor or final seller may provide a warranty on items sold outside these areas.
5. Comfort-Aire will not be liable for damages if our performance regarding warranty resolution is delayed by events beyond our control including accident, alteration, abuse, war, government restrictions, strikes, fire, flood, or other acts of God.

### HOW TO SUBMIT A WARRANTY CLAIM

If you have a warranty claim, notify you installer or dealer promptly.

## KEEP THIS INFORMATION AS A RECORD OF YOUR PURCHASE

### PRODUCT IDENTIFICATION

Model Number \_\_\_\_\_

Date of Purchase \_\_\_\_\_

*Remember to retain your bill of sale as proof of warranty period.*

Due to ongoing product improvements, specifications and dimensions are subject to change and correction without notice or incurring obligations. Determining the application and suitability for use of any product is the responsibility of the installer. Additionally, the installer is responsible for verifying dimensional data on the actual product prior to beginning any installation preparations.

Incentive and rebate programs have precise requirements as to product performance and certification. All products meet applicable regulations in effect on date of manufacture; however, certifications are not necessarily granted for the life of a product.

Therefore, it is the responsibility of the applicant to determine whether a specific model qualifies for these incentive/rebate programs.

*Comfort-Circ®*

1900 Wellworth Ave., Jackson, MI 49203 • Ph. 517-787-2100 • [www.marsdelivers.com](http://www.marsdelivers.com)